

Building Type : Hospitality
Climate Zone : Composite
Area : 3511.7m²
WWR : 34 %
Occupancy Type : 24 hours
ECBC Compliance: Prescriptive method
(ECBC 2017)

Lighting Power Density

LPD for dormitory: 7 W/ m² as per Building Area method.

Fixtures :LED Bulbs

Occupancy Sensors :in corridors, toilets, offices and conference rooms

Exterior Lighting Details

LED fixtures with minimum efficacy of 80 lumens/watt

Boys Sports Hostel Ambala, (Haryana)

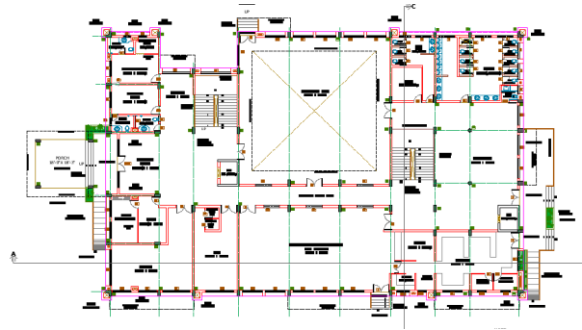

Some of the sample text in this document indicates the name of the style applied, so that you can easily apply the same formatting again. To get started right away, just tap any placeholder text (such as this) and start typing.

Want to insert a picture from your files or add a shape, text box, or table? You got it! On the Insert tab of the ribbon, just tap the option you need.

Building Envelope

Opaque wall : 20 mm Plaster + 115 mm AAC blocks + 20 mm air cavity 230 mm AAC blocks + 20 mm Plaster

U-value :0.425 W/m²

Assembly thickness : 405 mm:

Roof Assembly: 10mm tiles + 20 mm cement screed+75 mm XPS insulation +20 mm cement screed+ 150mm RCC slab

U-value: 0.33 W/m²K

Assembly thickness : 275 mm

Glazing type 1 :DGU(Double Glazed Unit)

U-value: 1.87 W/m²K, SHGC: 0.28, VLT: 26%

Glazing type DGU(Double Glazed Uni

U-value: 1.87 W/m²K, SHGC: 0.26, VLT: 23%

Glazing type 2: Single Glaze Unit

U-Value, 5.4 W/m² K

ECBC requirement of 20% hot water through solar water heaters